

# Thank you!

Thank you to all of the many people who make WoodFair possible. Our sponsors, our steering committee, our judges, our volunteers, the vendors, the woodworkers who enter the exhibition, everyone at Almquist Lumber Co., our media sponsors who help get the word out, all the people who provide great food, the people who donate raffle and silent auction prizes, and the people who provide demonstrations and classes, all deserve our thanks for helping to maintain the tradition of WoodFair and its celebration of wood. We thank College of the Redwoods for establishing this fine tradition, for administering the WoodFair classes, and for help with publicity and printing.

Finally, thank you to the public whose enthusiasm for WoodFair keeps us going.

Thank you!

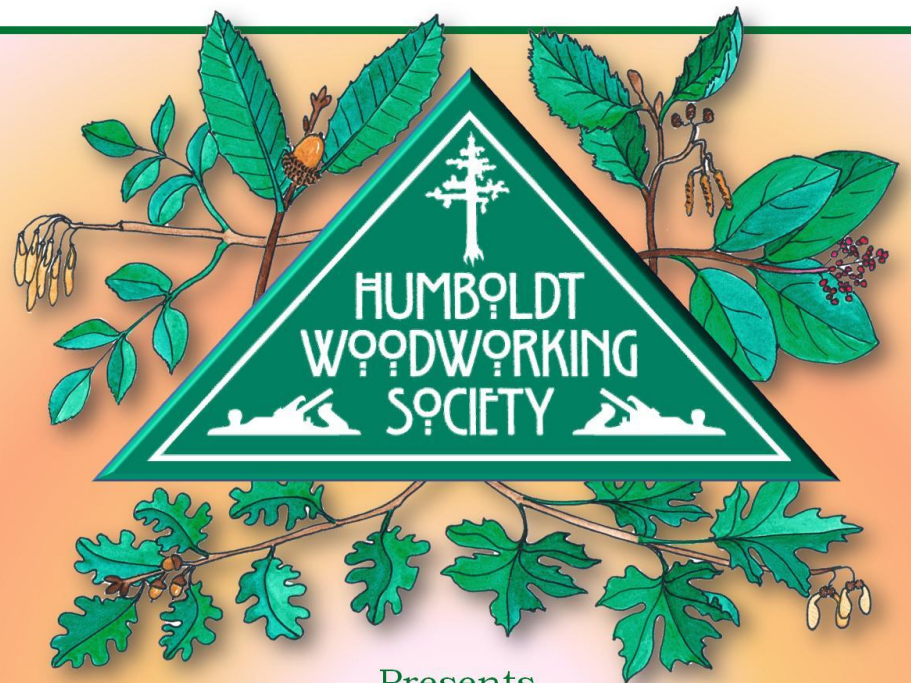

Presents

# WoodFair 2010

## July 10-11

Hosted by



Educational  
Partner



# PROGRAM

<b>Saturday</b>	
10:00 AM	Traditional and Contemporary Music for the Marimba: Tyler Hunt, Tricia Baxter
11:00 AM	Winsome Winds plays Old and New Classical Clarinet Duets: Joyce Carter and Tina Garsen
NOON	Striped Pig plays Old Time String Band Music: Colin Vance, Brian Letts, Cisco Haggerty, Matt Brunner
1:30 PM	WoodFair String Quartet (Mie Matsumoto (cello), Harriet Goble (violin), Anita Fullbright (violin), George Ingraham (viola))
3:00 PM	Singer, Song Writer Harry Fleishman Plays Acoustic Rhythm and Blues Guitar
4:00 – 7:00 PM	Guano plays California Hillbilly Surfer Music into the evening for the BBQ: Rick Bitter, Pat Anderson, Rod Hershberger and Adam Canter
<b>Sunday</b>	
10:00 – 11:30 AM	Traditional and Contemporary Music for the Marimba with Tyler Hunt, Tricia Baxter
NOON	Guano plays California Hillbilly Surfer Music: Rick Bitter, Pat Anderson, Rod Hershberger and Adam Canter
1:30 PM	WoodFair String Quartet Mie Matsumoto (cello), Harriet Goble (violin), Anita Fullbright (violin), George Ingraham (viola)
3:00 PM	Singer, Song Writer Harry Fleishman Plays Acoustic Rhythm and Blues Guitar
4:00 PM	Winsome Winds Jazz and Eclectic Clarinet Duet with Joyce Carter and Tina Garsen



Welcome to the 21<sup>st</sup> annual WoodFair. This is the third year that Humboldt Woodworking Society, Almquist Lumber Company, and College of the Redwoods have collaborated in the presentation of WoodFair. This is the premier celebration of wood the North Coast has to offer. We hope to continue this fine tradition for at least 21 more years to come.

This is one of many activities that Humboldt Woodworking Society participates in each year. As a nonprofit organization, we strive to increase public awareness and knowledge about woodworking, to support and provide woodworking education, both formal and informal, and to foster best practices in woodworking including sustainable use of wood and woodworking techniques that produce durable objects of beauty and utility, while encouraging community among woodworkers.

Enjoy WoodFair 2010!

Stephen Baer, President  
Humboldt Woodworking Society

# Events Saturday July 10

# Sponsors

9:00 AM	WoodFair 2010 Opening Ceremony, Welcome by Stephen Baer, Humboldt Woodworking Society – Main Entry
9:15 AM	Awarding of Prizes for the Exhibition – Bert Hafar, Head Judge – Main Entry
10:00 AM	Choosing the Right Saw Blades and Router Bits for Safe and Effective Woodworking -- Scott Steenson of Freud – Seminar Area
10:00 AM – Noon	Woodturning with Jerry Kermode – Woodturning Area
10:00 AM – 4:00 PM	Portable Saw Mill Operation by Kevin Taylor of Granberg International - Outside
10:00 AM – 5:00 PM	All Carvers Welcome! Demonstrations by Paul Kinsey, Chip Carving, and Monica Shell Miniature Carving - Carvers' Corner
11:00 AM	Getting Started in Guitar Making with Harry Fleishman of the Lutherie School International – Seminar Area
NOON	Using the Festool Kapex – Dual Laser Equipped Sliding Compound Miter Saw with Zach Sundstrom – Seminar Area
1:00 PM	Marquetry with Greg Zall – Seminar Area
2:00 PM	EnviroTex Pour-On Finish with Hilary Stephens – Seminar Area
2:00 – 4:00 PM	Woodturning with Jerry Kermode in the Woodturning Area
3:00 PM	Intarsia with Sandy Dardenelle – Seminar Area
4:00 PM	Introduction to Swiss-Style Carving with Craig Barnes in the Seminar Area
5:00 PM	WoodFair closed to the public
5:00 – 7:00 PM	BBQ for WoodFair participants prepared by Blackberry Bramble Barbecue

The sponsor collage includes the following logos and text:

- PIERSON BUILDING CENTER** (Circular logo with a hammer and saw)
- L. E. A. F. Living Education & Art Foundation** (Text logo)
- HUMBOLDT WOODWORKING SOCIETY** (Logo with a tree and a cross)
- Environmental Technology Inc.** (Text logo)
- COLLEGE OF FOUNDATION THE REDWOODS** (Circular logo with a tree)
- CRESTMARK ARCHITECTURAL MILLWORKS** (Text logo)
- marimba one** (Logo with a marimba instrument)
- CALIFORNIA URBAN LUMBER** (Logo with a tree and text 'A DIVISION OF JFC CONSTRUCTION')
- GREEN DIAMOND RESOURCE COMPANY** (Logo with a diamond shape)
- Scott Forbes** (Logo with a workshop scene)
- NORTHERN CALIFORNIA SAFETY CONSORTIUM** (Logo with three overlapping circles)
- Almquist lumber company** (Text logo)
- Custom Cabinets** (Text logo with contact info: Fortuna, CA, (707) 845-6093, (707) 725-1861, www.oestercabinets.com)
- KHSU-FM 90.5 DIVERSE PUBLIC RADIO** (Text logo)
- NEWS CHANNEL 3** (Logo with NBC peacock)
- KHUM 104.7FM • 104.3FM HUMBOLDT COUNTY** (Text logo)
- Kxgo 99.3 FM** (Logo with a tree and city skyline)
- the POINT 100.3 • 102.7** (Logo with a triangle and text 'THE BEST ROCK W/ROLL OF ALL TIME, ALL THE TIME')

# Sponsors

Almquist Lumber Co.  
 Barnum Timber Co., Inc.  
 Rosebud Woodworking  
 North Coast Safety Consortium  
 Community Action Team, Humboldt Redwood Co., LLC  
 Green Diamond Resource Co.  
 College of the Redwoods Foundation  
 Humboldt Woodworking Society  
 Forbes Cabinets  
 Whitethorn Construction Hardwood Division  
 Living Education and Art Foundation  
 John and Barbara MacEvoy  
 Crestmark Architectural Millworks, Inc.  
 Pierson Building Center  
 California Urban Lumber of Martinez, CA  
 Urban Lumber Co. of Springfield, OR  
 Fortuna Custom Cabinets  
 Marimba One, Inc.  
 Environmental Technology, Inc.  
 J R Stephens Company  
 KEIM News Channel 3  
 Lost Coast Communications  
 (KHUM, The POINT, KXGO)  
 KHSU FM Radio

# Events Sunday July 11

6:00-9:00 AM	Hardwood Entrepreneurs' Breakfast Meeting – Hosted by Susan Bicknell, By Invitation Only, Almquist Mezzanine.
9:00 AM – 5:00 PM	All Carvers Welcome! Carvers' Corner
10:00 AM	Building a Raised Panel Door -- Scott Steenson of Freud – Seminar Area
10:00 AM – Noon	Woodturning with Jerry Kermode – Woodturning Area
10:00 AM – 4:00 PM	Portable Saw Mill Operation by Kevin Taylor of Granberg International - Outside
11:00 AM	How Guitar Makers Bend Wood with Harry Fleishman of the Lutherie School International – Seminar Area
NOON	Sharpening Woodworking Tools with Bill Hole – Seminar Area
1:00 PM	Marquetry with Greg Zall – Seminar Area
2:00 PM	Inlay and Techniques of Neck Construction in the Banjo World with Colin Vance – Seminar Area
2:00 – 4:00 PM	Woodturning with Jerry Kermode in the Woodturning Area
3:00 PM	Analysis of Releif Carving with Craig Barnes – Seminar Area
4:00 PM	The Festool Modular System Tools and How to Use Them with Zach Sundstrom of Festool - Seminar Area
5:00 PM	WoodFair Closes

**Enroll for these classes through College of the Redwoods, Community Education and Development (269-4000)**

**Woodturning I: Between Center Turning** – Jerry Kermode – Monday, July 12, 9 AM -5 PM CR AT 109 (\$180)

**Woodturning II: Faceplate Turning** – Jerry Kermode – Tuesday, July 13, 9 AM -5 PM CR AT 109 (\$180)

**Woodturning III: Advanced Woodturning** – Jerry Kermode – Wednesday, July 14, 9 AM -5 PM CR AT 109 (\$180)

**Marketing I: Taking the Starving Out of Artist and Budget Based Pricing** – Deborah Kermode – Monday, July 12, 10 AM – 4 PM CR AT 106 (\$85)

**Marketing II: Marketing and Selling Your Work** – Deborah Kermode – Tuesday, July 13, 10 AM – 4 PM CR AT 106 (\$85)

**Fine Woodworking Techniques I: Introduction to Furniture Making** – JoAnn Schuch – Saturday, July 10, 9 AM – 1 PM at WoodFair School at Almquist Custom Mill (FREE)

**Fine Woodworking Techniques II: Mortise and Tenon** – Joel McCoy – Sunday, July 11, 9 AM -12 PM at WoodFair School at Almquist Custom Mill (\$65)

**Fine Woodworking Techniques III: Hand Cut Dovetails** – Joel McCoy – Sunday, July 11, 1 – 4 PM at WoodFair School at Almquist Custom Mill (\$60)

**Marquetry I: Introduction to Marquetry for Contemporary Furniture** – Greg Zall – Monday – Wednesday, July 12 – 14, 8 AM – 5 PM, CR AT 108 (\$375)

**Marquetry II: Marquetry Master Class** – Greg Zall – Thursday, July 15, 8 AM – 5 PM CR AT 109 (\$150)

**Basic Carpentry Skills for Women** – Doralee Smith and Barry Smith – Saturday, July 10, 2 PM – 5:30 PM at WoodFair School at Almquist Custom Mill (\$60) Sponsored by Pierson Building Center

**Architectural Restoration of Historic Windows** – Bill Hole – Monday, July 12, 1 – 5 PM, Annie B. Ryan House, 1000 F. Street, Eureka (\$25) Sponsored by the Eureka Heritage Society

Joseph Amaral, Fine Furniture  
Stephen Baer, Pacific Laser  
Humboldt Woodworking Society  
Craig Barnes, Sculptor  
Rick Beale, RB Woodworks  
John H. Bengel, Scroll Saw Clocks and Boxes  
John Bennet, Nature Carving from Local Woods  
John T. Brugaletta, Wood Turner  
Alan Clark, Blackberry Bramble Barbecue  
Dennis Cook, Redwood Garden Structures  
Tom Cover, Wood Turner  
Charles Dame, Charlie's Woodcraft  
Harry Fleishman, Lutherie School International  
Justin Forbes, Custom Cutting Boards and Mirrors  
Bert Hafar, Trivets, Sushi Boards and Hand Mirrors  
College of the Redwoods Construction Technology Program  
Greg Huffman, Marimba One  
Matthew Isaac, Mat Isaac's Woodworks  
David Kelley, Custom Designs  
Humboldt Wildlife Care Center  
Jesse Maluchnik, Maluchnik Furnishing and Cabinetry  
Jill McClure, McClure Products  
Steve and Marilyn McKinney, Breadboards & Band Saw Boxes  
Jon Nickelson, Nickelson Woodworking  
Jill Plumb, Art of the Garden  
Bill Ridings, California Urban Lumber  
Seth San Filippo, Urban Lumber Company  
Bob Spore, "Bob Turns"  
Scot Steenson, Freud Tools  
Hilary Stephens, Environmental Technology, Inc.  
Bruce Stephens and Del Kauffman, Furniture  
Earl Stevens, Intarsia  
Zach Sundstrom, Festool  
Kevin Taylor, Granberg Portable Saw Mills  
Colin Vance, Vance Banjos  
Barry VanSickle, B & L Enterprises

# WoodFair 2009 Exhibition Winners

**Best of Show** - Jason Straw - Incunabula (Cabinet)

**Most Creative** - Jean -Luc Thornton - Elixia Fountain

## **Fine Furniture and Cabinetry**

First - Matthew Bunnell - Chest of Drawers

Second - Greg Jurrens - Elliptical Table with Drawers

Third - Heather Trosdahl - Pinwheel Café Table

Student - Kai Herd - Spring (Occasional)

Honorable Mention:

Susan Bicknell - Yellow Orchid Demilune

John Einloth - Big Oval Cabinet

Dan Graziani - Hall Table

Mat Isaac - Desk; Ari Lane - Bureau

Ben Williams - Mission Dining Table

## **Sculpture and Carving**

First - Rip Kirby - Bass Player, Drummer, Sax Player,  
Trumpet Player

Second - Craig Barnes - The Green Man Pedimental  
Ornament

Third - Gloria Dinsmore - American Kestral

Student - Jason Straw - Brain Matter

Honorable Mention - Monica Shell - Free Spirit Statue

## **Woodturning**

First - Tony Chess - Vessel

Second - Tony Chess - Bowl

Third - Wayne Roe - Platter

Honorable Mention - Tony Chess - Geode

## **All Other Woodworking**

First - Larry Dern - Cedar Strip Kayak

Second - Troy Hedland - Two Bows, Asiatic Recurved and  
Long Bow

Third - Susan Bicknell - Red Daylilies Marquetry

Student - Will Madaras - Violin

Honorable Mention - Robert Kammerer - Bench

Steve and Marilyn McKinney - Band Saw Jewelry Box

# Judges and Steering Committee

## **Judges**

Bert Hafar, Head Judge, Associate Faculty and Instructional  
Aide, Construction Technology, College of the Redwoods

Janis Taylor, Wood and Ceramic Artist

Leonard Bechler, Professional Woodworker, CR Fort Bragg  
Alumnus

Paul Kinsey, Professor of Construction Technology, College of  
the Redwoods

Bill Hole, Professor of Historic Preservation and Restoration  
Trades, College of the Redwoods

Jeni Sue Wilburn, Woodworker and Inventory Manager,  
Almquist Lumber Company

## **Steering Committee and Logistics Team**

Susan Bicknell, Coordinator

Stephen Baer, President, HWS

Bert Hafar, WoodFair Classes Facilitator

Kimn Cabrerra, Lynn Dixon, Don Bicknell

HWS Board of Directors

Eric Almquist and Jeni Sue Wilburn, Almquist Lumber Co.

Harvey Raider, Volunteer Facilitator and Music Facilitator

Joel McCoy, Demonstrations Facilitator

Douglas Boileau, Safety Czar

Sue MacConnie, Parking Facilitator

Dennis Burges, On Site Fundraising Facilitator

Monica Shell, Registrar

Sue Cook, Head Docent

Will Madaras, Set Up and Take Down Leader

# WoodFair 2010

## Exhibition Entries

### Fine Furniture

Frank Antonio Bird,  
Sommelier Table,  
Tablette Ungulate, and  
Big Two-Hearted Bottlebrush Table Tops

David Grant, Redwood Table

James H. Heimbach, Maloof Inspired Rocker

Anthony Kahn, Dining Table and Six Chairs

Dennis Musselman,  
New England Fanback #37 and  
Pair of Windsor-Style Bar Stools

Ed Nazemi, Occasional Table

John Onstine, Table

Thomas Starbuck Stockton, Demilune Table

### Cabinetry and Casework

Susan Bicknell, Cynthia's Nasturtium Console

Gregg Jurrens, Six Drawer Chest

Bradley Oliver, Root Beer Jewelry Cabinet

Matthew Bunnell,  
Tambour and  
Hutch

Jerry Cousins, Tulip Blanket Chest

### Woodturning, Sculpture, and Carving

Gloria Dinsmore, Wood Duck

Craig Barnes, Male Torso

Douglas Beck, Imagination

Tony Chess, Tannins + Iron + Ink,  
Spalted Oregon White Oak Natural Edge Bowl, and  
Bay Laurel Indian Pot

Tom Cover, Alder Magic, and  
Four Goblets

Rip Kirby, Meditating Sumo, and  
A Woodcarver Carving a Woodcarver

Tom Lisle, Rufa Ant, and  
Army Ant

Monica Shell, The Herd (Sculpture)

Bob Spore, Pepper Mill

Brent Cook, Hand Carved Bowl

### Novice

Sue MacConnie, Craftsman Stand

### All Other Woodworking

Richard Berlin, Wells Fargo Stage Coach Miniature

Harry Fleishman, Swallow (Guitar)

Earl Stevens, The Beginning of the Trail (Intarsia)

Colin Vance, Black Lacquered Rock Maple Five-String Banjo



Jason Straw (Fort Bragg, CA):  
 Incunabula (Rosewood, Pear,  
 Madrone Burl, Port Orford Cedar)  
 (48" h, 36" w, 24" d) Best of Show,  
 WoodFair 2009

**MAP**

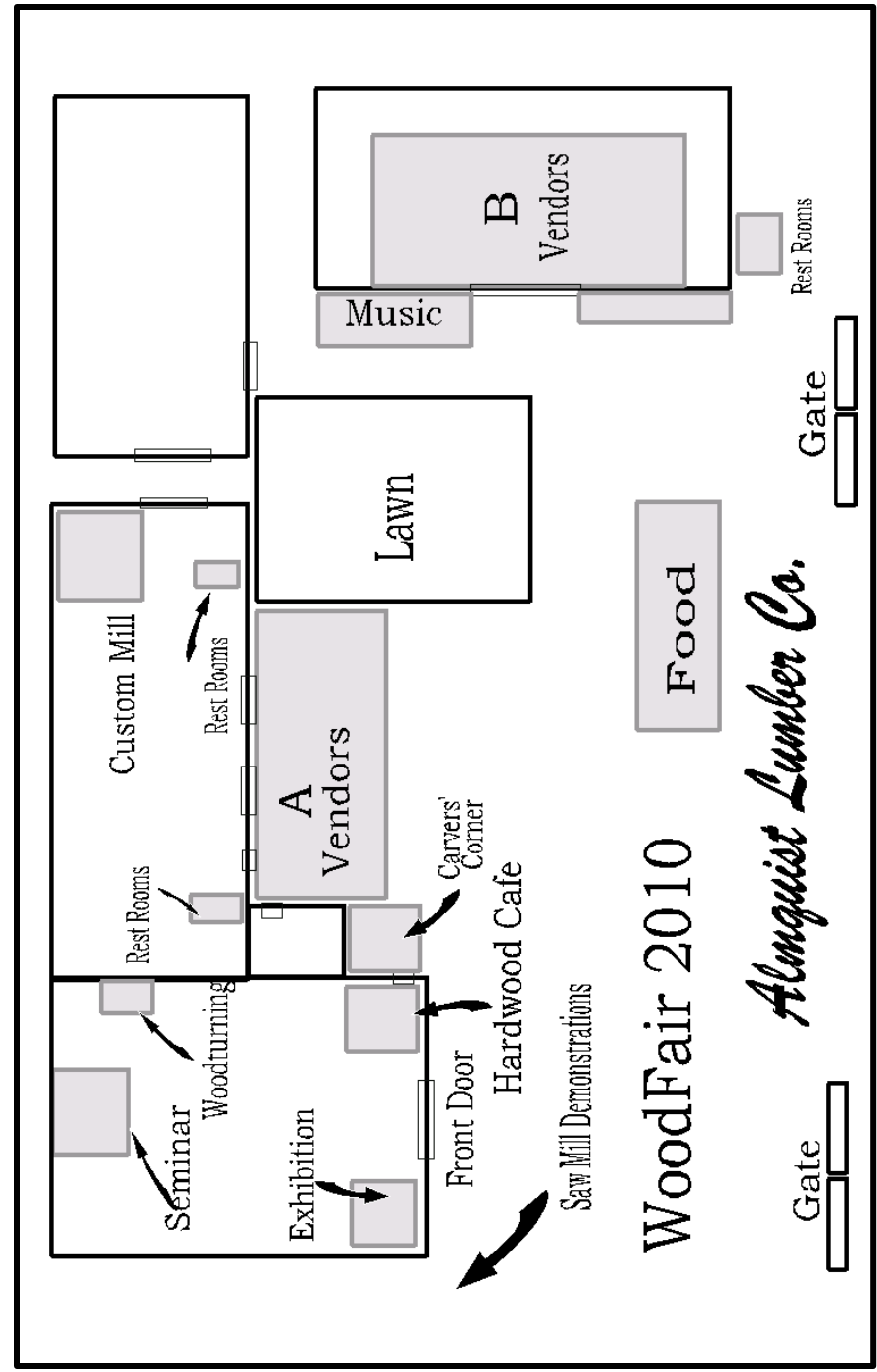

WoodFair 2010

*Alquist Lumber Co.*